

ORDINANCE NO.

P - P 66-7

AN ORDINANCE AMENDING KING COUNTY RESOLUTION NO. 25789, AS AMENDED BY AUTHORIZING A PLANNED UNIT DEVELOPMENT ON CERTAIN PROPERTY.

WHEREAS CAMELOT has petitioned King County requesting approval of a planned unit development on property described in said petition and all legal requirements have been performed; and

WHEREAS the Department of Planning has transmitted to the King County Council, King County, Washington, a copy of the Department's findings and action recommending approval of this planned unit development;

NOW, THEREFORE, BE IT ORDAINED that the King County Council does hereby adopt the findings and recommendation of the Department of Planning as its own and does hereby approve the final plans for Planned Unit Development as shown in Exhibit(s) CC attached hereto and made a part hereof as located hereon and legally described herein, which lies within the part(s) of the Zoning Map described as Area Map(s) E 4-21-4

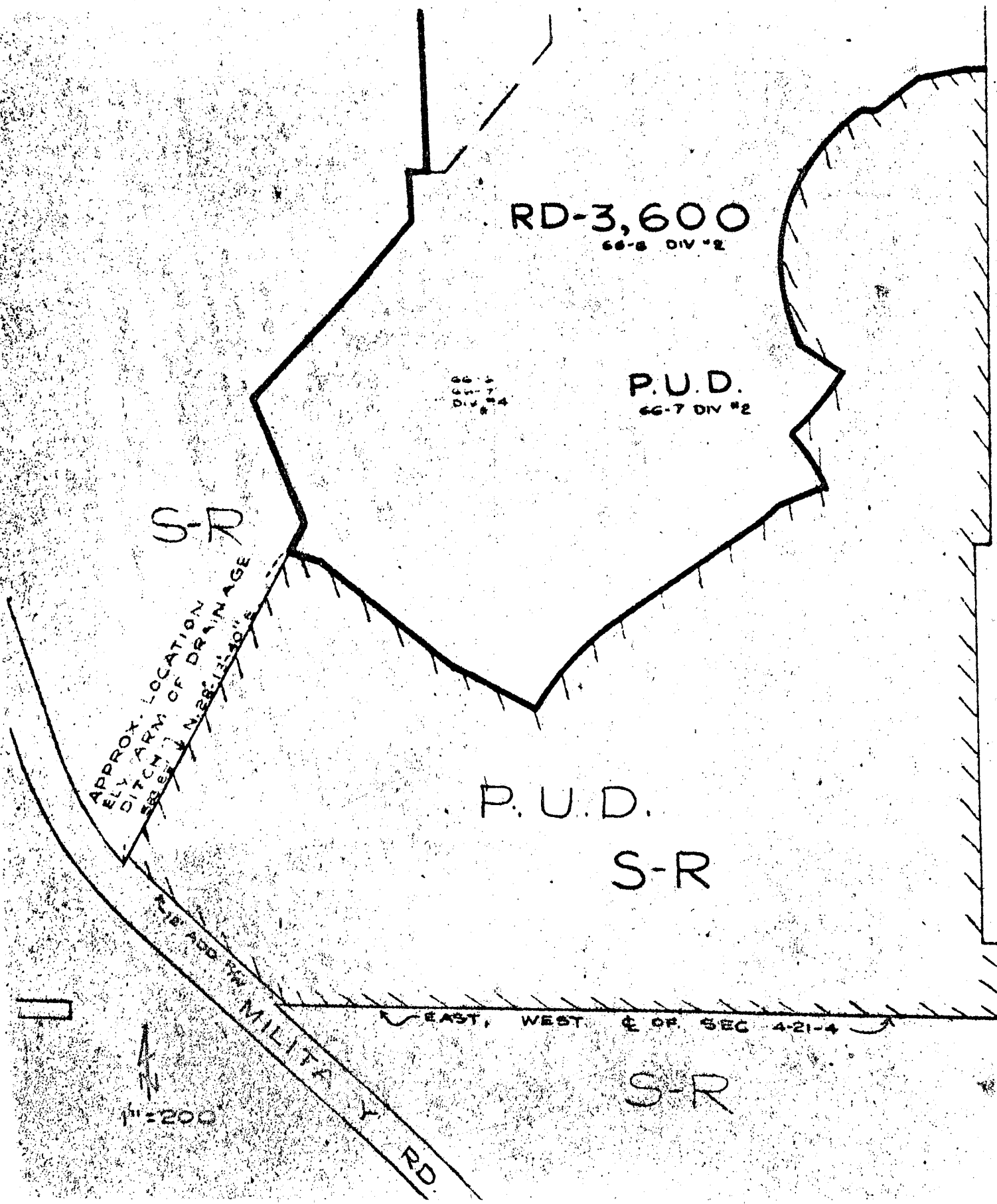

I.S.H. N°5

1"=200'

EAST, WEST E OF SEC 4-21-4

LEGAL DESCRIPTION:

That portion of the northeast quarter of Section 4, Township 21 North, Range 4 East, W. M. in King County, Washington, described as follows:

Commencing at the east quarter corner of said section; thence N 88°18'00" W along the east and west centerline of said section 493.96 feet to intersect the west margin of the Seattle-Tacoma Freeway, as shown on map titled "Primary State Highway No. 1, Pierce County Line to Jct. SSH No. 5-A, King County" and approved by the Washington State Director of Highways on October 28, 1958 for Right-of-Way, Sheet 13 of 20 sheets and the Point-of-Beginning; thence continuing N 88°18'00" W along said centerline of section 1062.56 feet to intersect the northeasterly margin of Military Road; thence N 43°08'00" W along said road margin 208.28 feet to the beginning of a curve to the right with a radius of 674.20 feet; thence northwesterly along said curve through a central angle of 6°15'00" an arc distance of 73.54 feet; thence N 28°13'40" E 583.85 feet; thence S 63°21'08" E 45.63 feet; thence S 43°08'00" E 236.26 feet; thence S 60°40'14" E 60.08 feet; thence S 57°32'33" E 80.00 feet to intersect the arc of a curve at a point from which the center lies S 57°32'33" E and 390.00 feet distant; thence northeasterly along said curve to the right through a central angle of 27°32'33" an arc distance of 187.48 feet to a point of tangency; thence N 60°00'00" E 272.37 feet; thence N 50°25'41" E 32.44 feet; thence N 71°27'11" E 80.00 feet to intersect the arc of a curve at a point from which the center lies S 71°27'11" W and 355.00 feet distant; thence northerly along said curve to the left through a central angle of 15°29'32" an arc distance of 95.99 feet to intersect the arc of a curve at a point from which the center lies N 37°13'37" W and 630.00 feet distant; thence northeasterly along said curve to the left through a central angle of 11°26'30" an arc distance of 125.81 feet; thence N 48°40'07" W 84.52 feet to intersect the arc of a curve at a point from which the center lies N 70°45'41" E and 285.00 feet distant; thence northerly and easterly along said curve to the right through a central angle of 78°30'23" an arc distance of 390.50 feet thence N 83°32'23" E 28.59 feet; thence N 52°12'17" E 68.35 feet thence N 78°18'39" E 80.00 feet; thence S 85°37'43" E 21.35 feet to said west margin of the Seattle-Tacoma Freeway; thence S 4°22'17" W along said Freeway margin 713.93 feet; thence N 85°37'43" W 25.00 feet; thence S 4°22'17" W 600.00 feet; thence S 85°37'43" E 25.00 feet; thence S 4°22'17" W 115.70 feet to the Point of Beginning; SUBJECT to modification of a portion of the southerly boundary, as described hereinabove by order of judgement entered in King County Superior Court Cause No. 687237 and filed on May 28, 1968 in Reel 167, Photos 876 through 883. Less County roads.

INTRODUCED and read for the first time this 11th day of August, 1969.

PASSED by the Council at a regular meeting thereof on the 18th day of August, 1969.

John T. O'Brien
Chairman of the County Council

ATTEST:

Roy Olson
Clerk of the Council
ACTING

APPROVED this 22nd day of August, 1969

[Signature]
King County Executive

ORDINANCE READINGS
1st Aug 16, 1969
2nd Aug 18, 1969
3rd Aug 18, 1969
Effective Date